



DATE: *December 24, 2024*

TO: *Worcester Conservation Commission*

FROM: *Robert C. Antonelli, Jr. – Assistant Commissioner, DPW and Parks*

SUBJECT: *Elm Park RDA Application for 01-13-2025 Meeting – Description of Work*

1. Purpose of Proposed Work:

- a. DPW and Parks is proposing, by public bid process, to perform renovations to the existing playground at Elm Park.

2. Scope of Proposed Work:

- a. Remove and replace existing Poured-in-Place (PIP) unitary safety surfacing, which no longer meets DPW and Parks current standard.
- b. Remove approximately 860 SF of existing adjacent bituminous asphalt pavement and replace with new PIP. The purpose is to connect and unify the five playground areas and allow the installation of the two proposed new saucer swings.
- c. Remove and replace or repair existing playground equipment (saucer swings and composite playground).

3. Schedule:

- a. Proposed Work schedule to be completed within 90 days of Award of Contract/Notice to Proceed or by June 01, 2025, whichever is sooner.

4. Existing Conditions - Representative Photographs – Area E



Existing 2-5 Age Group Play Equipment Climber and Slide and view of existing swing sets located in Area A, in the background.



Area E - proposed removal of existing bituminous asphalt walkway between playground equipment Area A and E and replace with PIP. Typical at four locations.



Zoom Out of area of proposed removal of existing bituminous asphalt walkway between playground equipment Area A and E.



View from Composite Playground in Area A and existing saucer swing in Area B in the background, proposed to be replaced.

5. Site Plan List

- a. EX-1 Limit of Work/Erosion Control**
- b. CC-1 General Conditions, Site Preparation & Proposed Renovations**
- c. CC-2 Typical Construction Detail – Expansion of PIP Safety Surfacing**
- d. Detail D4 – Concrete Curb**
- e. Detail D5 – Loam and Seed**
- f. Detail D7 – Erosion Control**
- g. Detail D9 – Poured-in-Place Rubber Safety Surfacing (PIP)**

**ELM PARK POND
(ELM MERE)**
AREA=4.7± ACRES
WATER ELEV.=491.2'
(MARCH 7, 2012)

**ELM PARK POND
(NORTH MERE)**
AREA=4.7± ACRES
WATER ELEV.=491.2'
(MARCH 7, 2012)

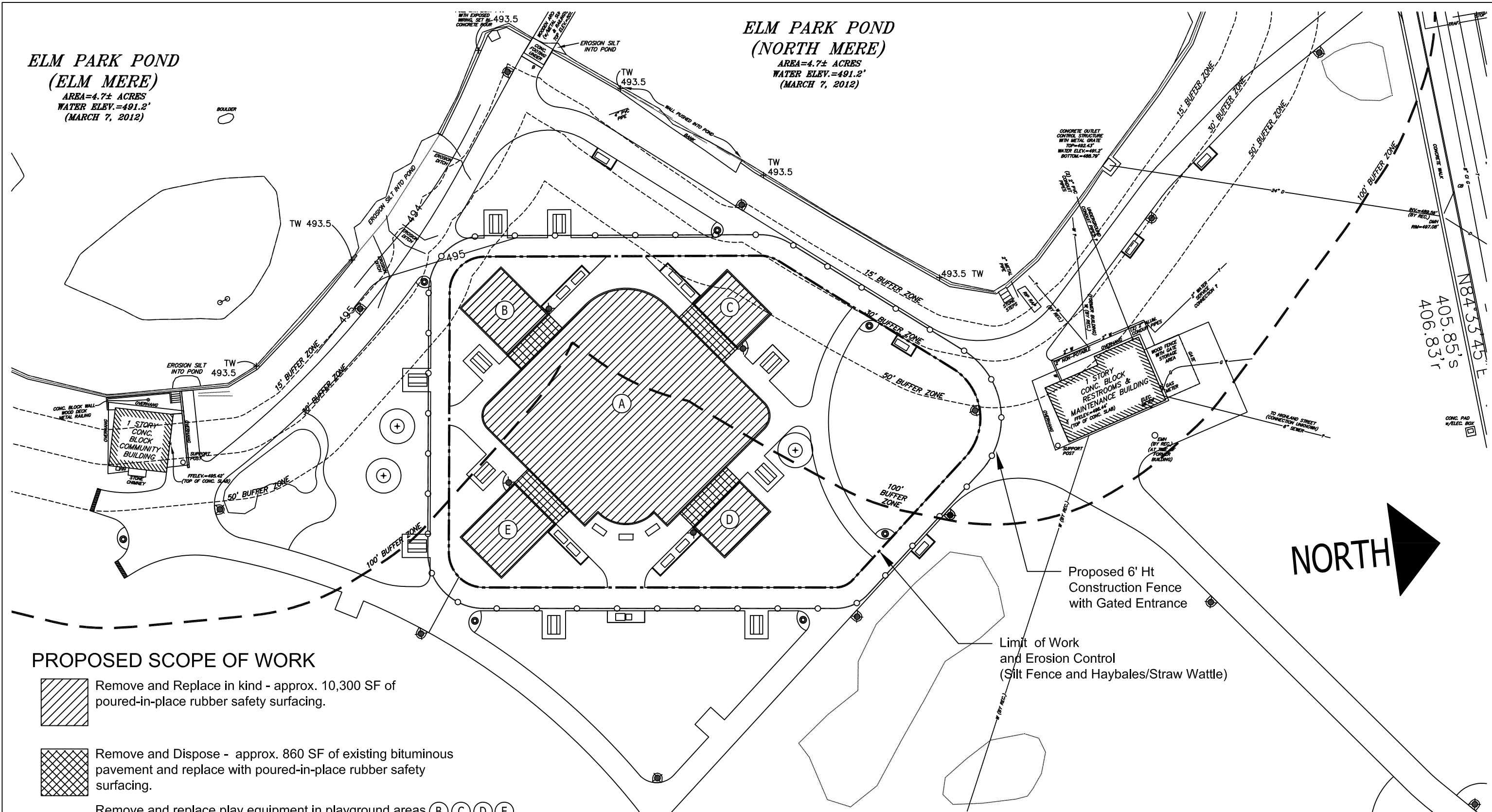

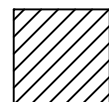
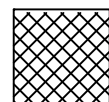

PROPOSED SCOPE OF WORK

-  Remove and Replace in kind - approx. 10,300 SF of poured-in-place rubber safety surfacing.
-  Remove and Dispose - approx. 860 SF of existing bituminous pavement and replace with poured-in-place rubber safety surfacing.
- Remove and replace play equipment in playground areas (B) (C) (D) (E) (will require ground disturbance for new concrete footing).
- Remove and replace play equipment in playground area (A) (will NOT require any ground disturbance).

Proposed 6' Ht Construction Fence with Gated Entrance

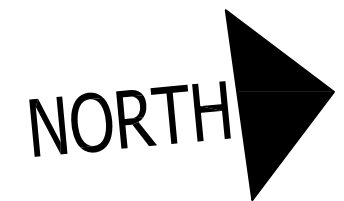
Limit of Work and Erosion Control (Silt Fence and Haybales/Straw Wattle)



	Dept. Of Public Works & Parks Capital Projects Division ROBERT C. ANTONELLI, JR. Assistant Commissioner	<p>ELM PARK PLAYGROUND LIMIT OF WORK /EROSION CONTROL</p> December 2024 NOT TO SCALE	EX-1
---	--	--	------

**ELM PARK POND
(ELM MERE)**
AREA=4.7± ACRES
WATER ELEV.=491.2'
(MARCH 7, 2012)

**ELM PARK POND
(NORTH MERE)**
AREA=4.7± ACRES
WATER ELEV.=491.2'
(MARCH 7, 2012)

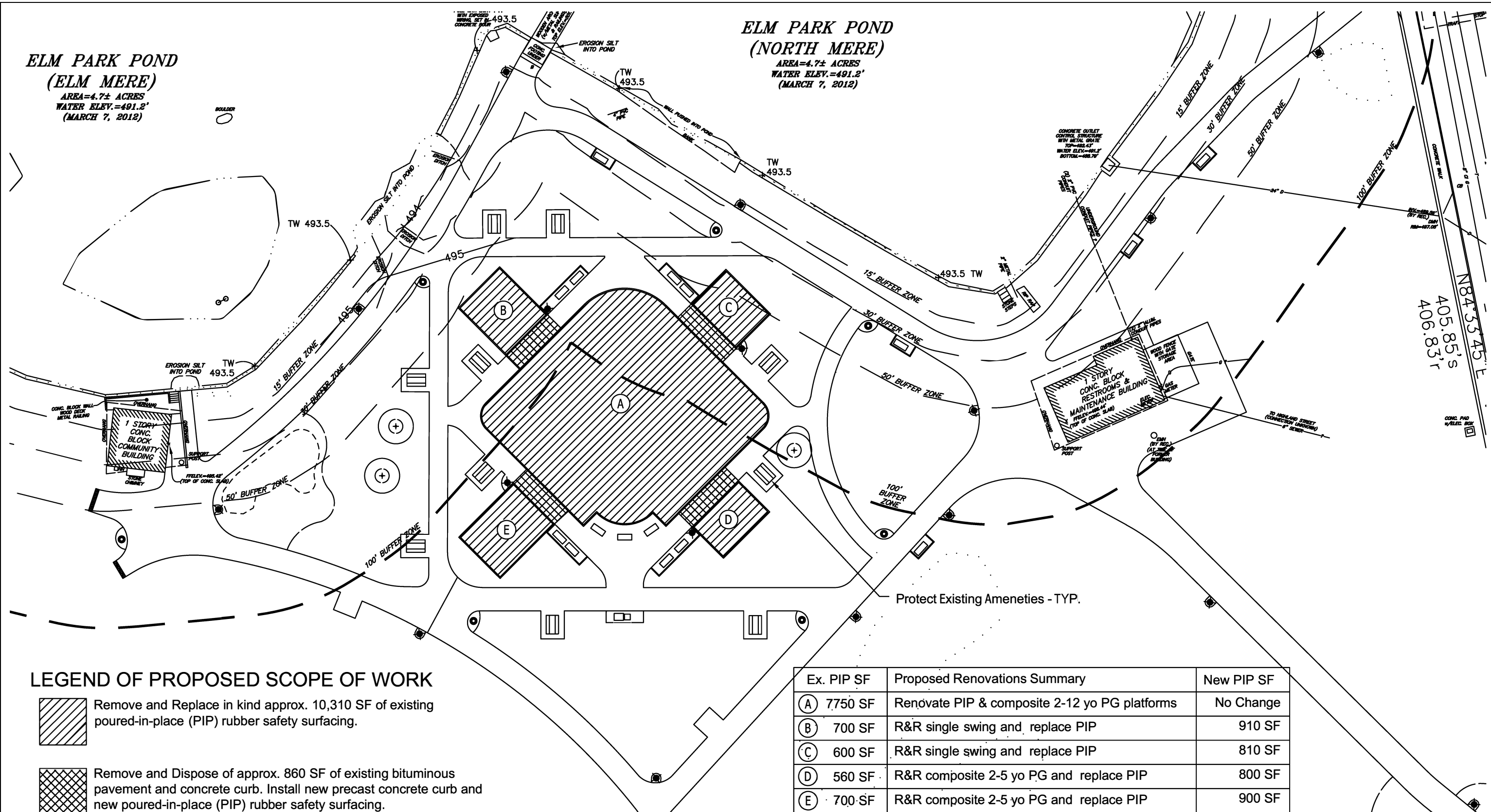

LEGEND OF PROPOSED SCOPE OF WORK

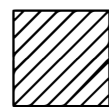
 Remove and Replace in kind approx. 10,310 SF of existing poured-in-place (PIP) rubber safety surfacing.

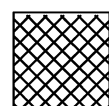
 Remove and Dispose of approx. 860 SF of existing bituminous pavement and concrete curb. Install new precast concrete curb and new poured-in-place (PIP) rubber safety surfacing.

Remove and replace play equipment in playground areas (B)(C)(D)(E) (will require ground disturbance for new concrete footing).

Remove and replace play equipment in playground area (A) (will NOT require any ground disturbance).

Ex. PIP SF	Proposed Renovations Summary	New PIP SF
(A) 7750 SF	Renovate PIP & composite 2-12 yo PG platforms	No Change
(B) 700 SF	R&R single swing and replace PIP	910 SF
(C) 600 SF	R&R single swing and replace PIP	810 SF
(D) 560 SF	R&R composite 2-5 yo PG and replace PIP	800 SF
(E) 700 SF	R&R composite 2-5 yo PG and replace PIP	900 SF



Dept. Of Public Works & Parks
Capital Projects Division
ROBERT C. ANTONELLI, JR.
Assistant Commissioner

**ELM PARK PLAYGROUND
GENERAL CONDITIONS, SITE PREPARATION
& PROPOSED RENOVATIONS**

DECEMBER 2024
NOT TO SCALE

CC-1

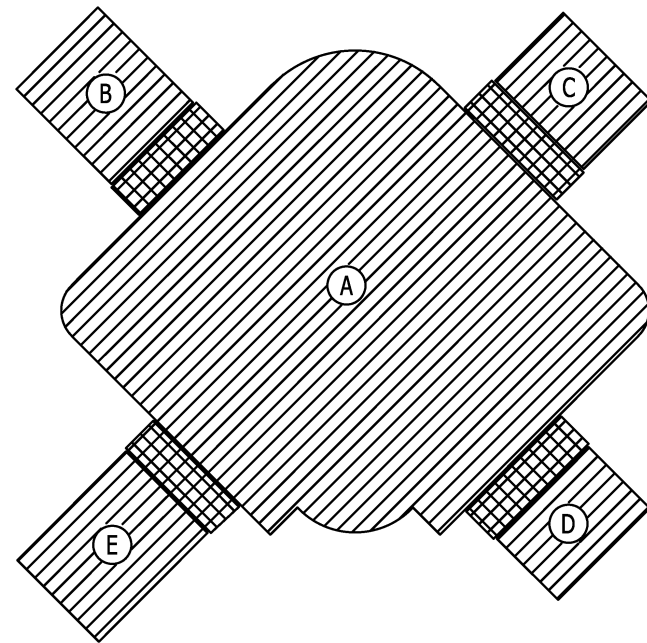

PROPOSED SCOPE OF WORK

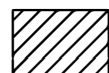
 Remove and Replace in kind approx. 10,310 SF of existing poured-in-place (PIP) rubber safety surfacing.

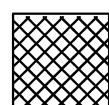
 Remove and Dispose of approx. 860 SF of existing bituminous pavement and concrete curb. Install new precast concrete curb and new poured-in-place (PIP) rubber safety surfacing.

Remove and replace play equipment in playground areas (B)(C)(D)(E) (will require ground disturbance for new concrete footing).

Remove and replace play equipment in playground area (A) (will NOT require any ground disturbance).

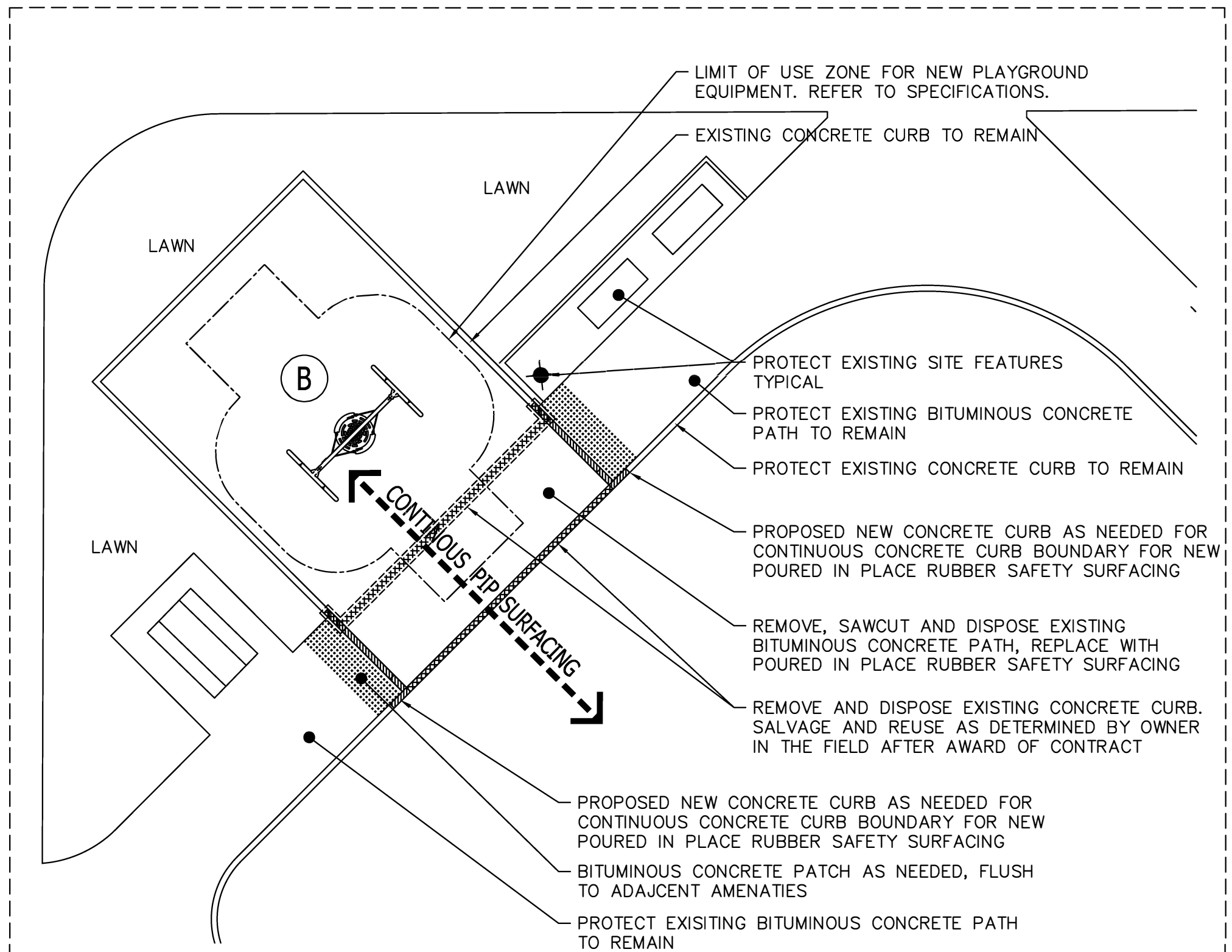

**** TYPICAL DETAIL: PROPOSED PREPARATION AND RENOVATIONS FOR AREAS B,C,D and E**



Dept. Of Public Works & Parks
Capital Projects Division
ROBERT C. ANTONELLI, JR.
Assistant Commissioner

PLAYGROUND RENOVATIONS - ELM PARK
****TYPICAL PROPOSED**
PREPARATION & RENOVATIONS

DECEMBER 2024
NOT TO SCALE

CC-2

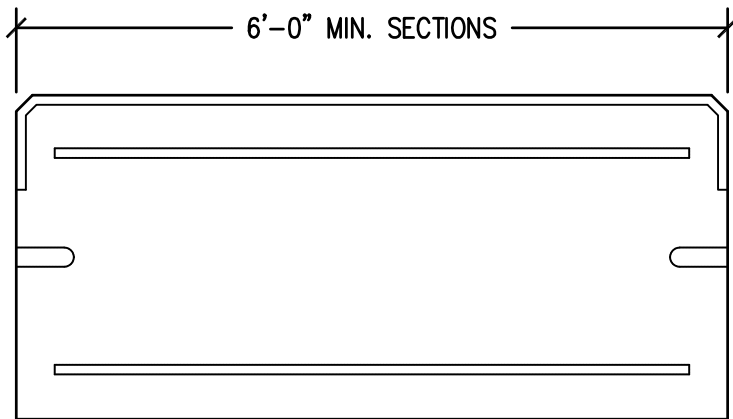
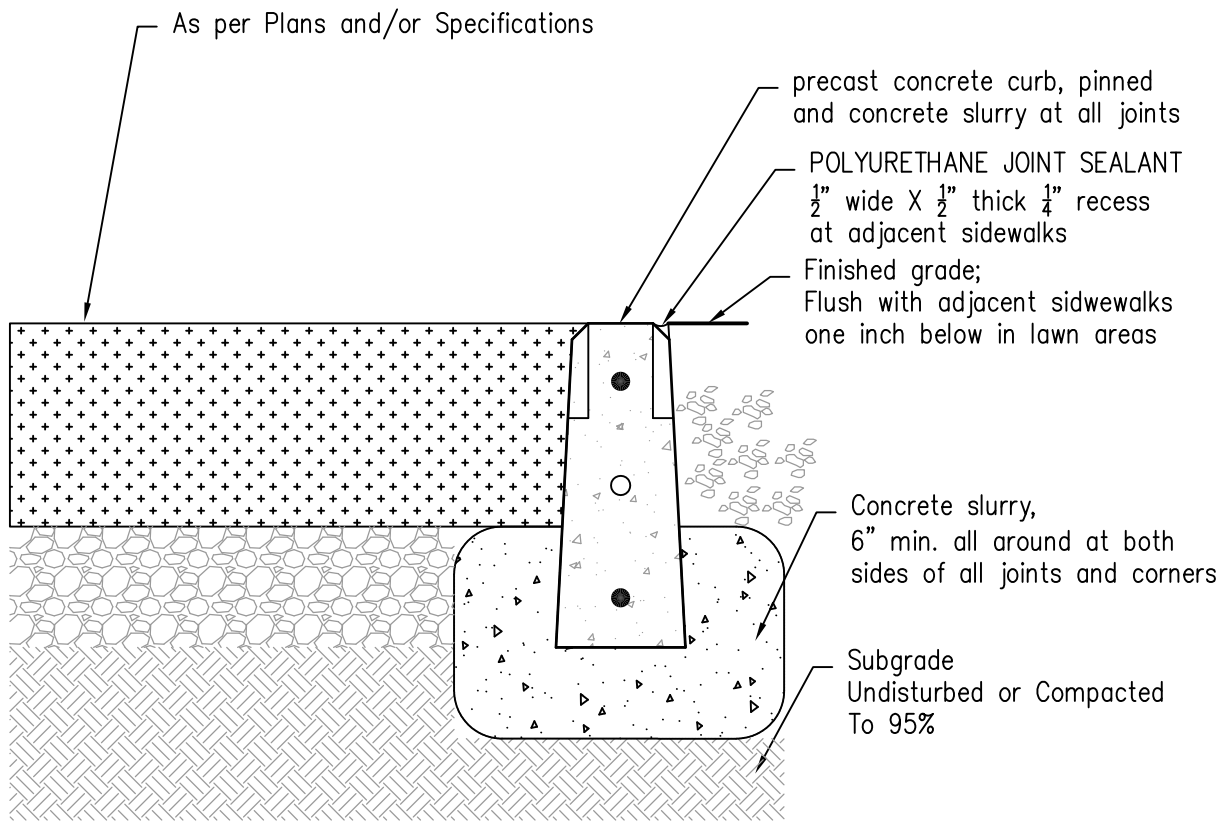

Elevation

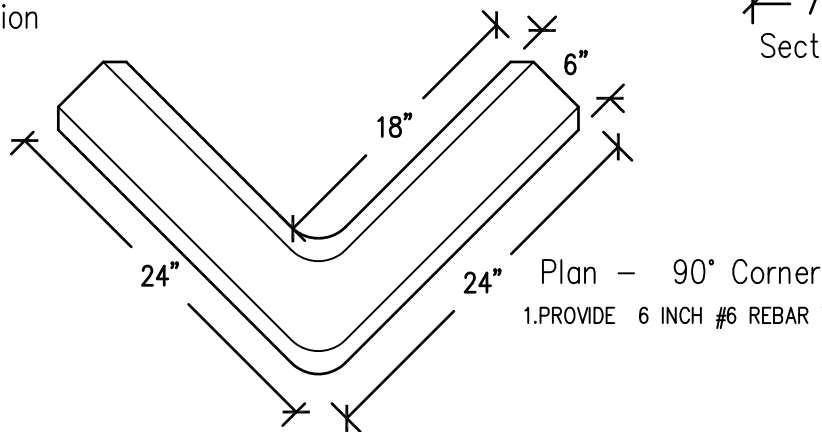
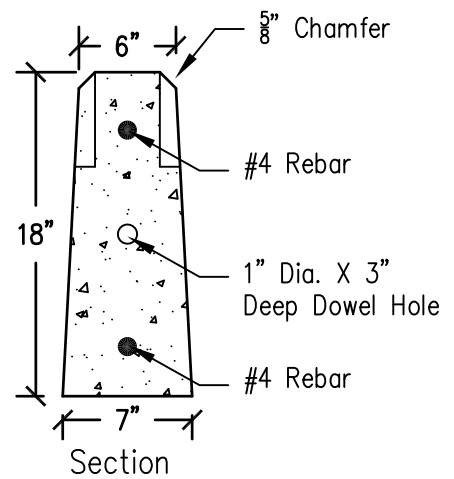

1. PROVIDE 6 INCH #6 REBAR TIE BETWEEN CURB SECTIONS



Dept. Of Public Works & Parks
 Capital Projects Division
 ROBERT C. ANTONELLI, JR.
 Assistant Commissioner

Parks, Recreation & Cemetery Division Standard
 Details - Concrete Curb and Typical Section

Not to Scale

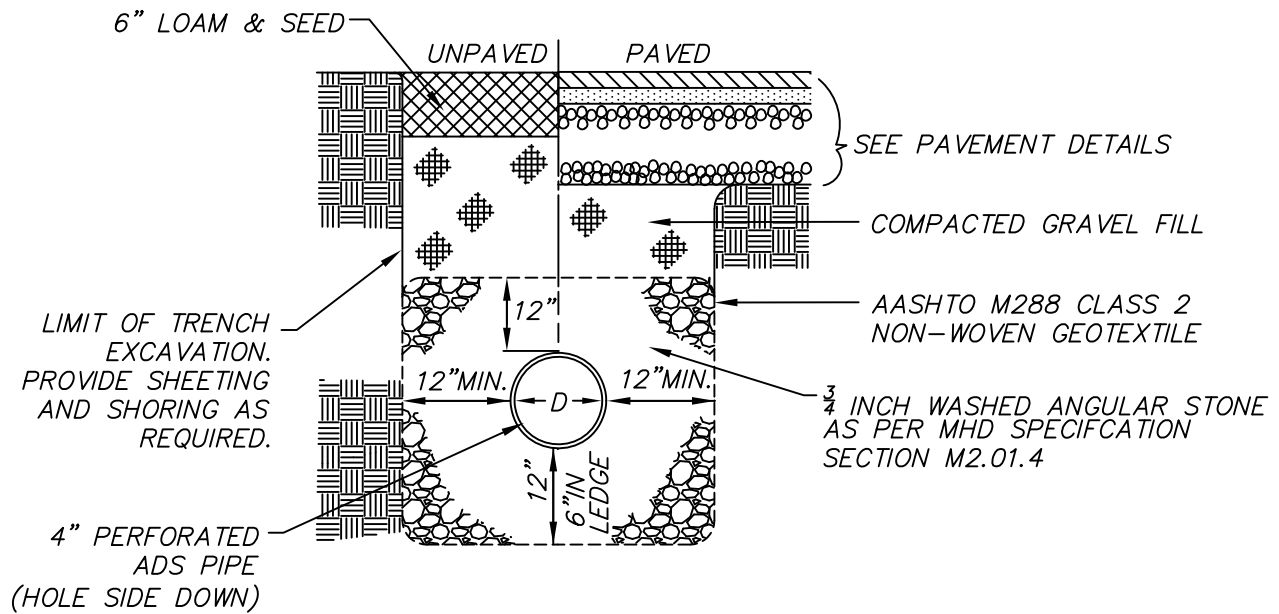

Perforated Pipe Subdrain (Not in Contract)

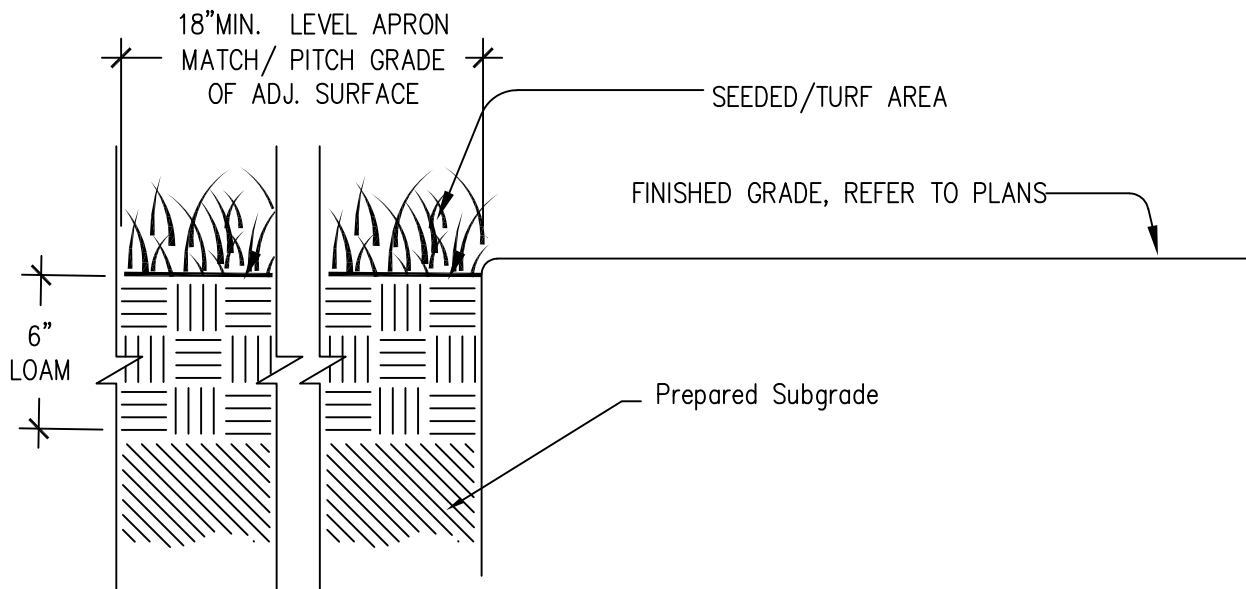

Loam and Seed



Dept. Of Public Works & Parks
Capital Projects Division
ROBERT C. ANTONELLI, JR.
Assistant Commissioner

Parks, Recreation & Cemetery Division Standard
Details - Perforated Pipe Subdrain and Loam and Seed

Not to Scale

D-5

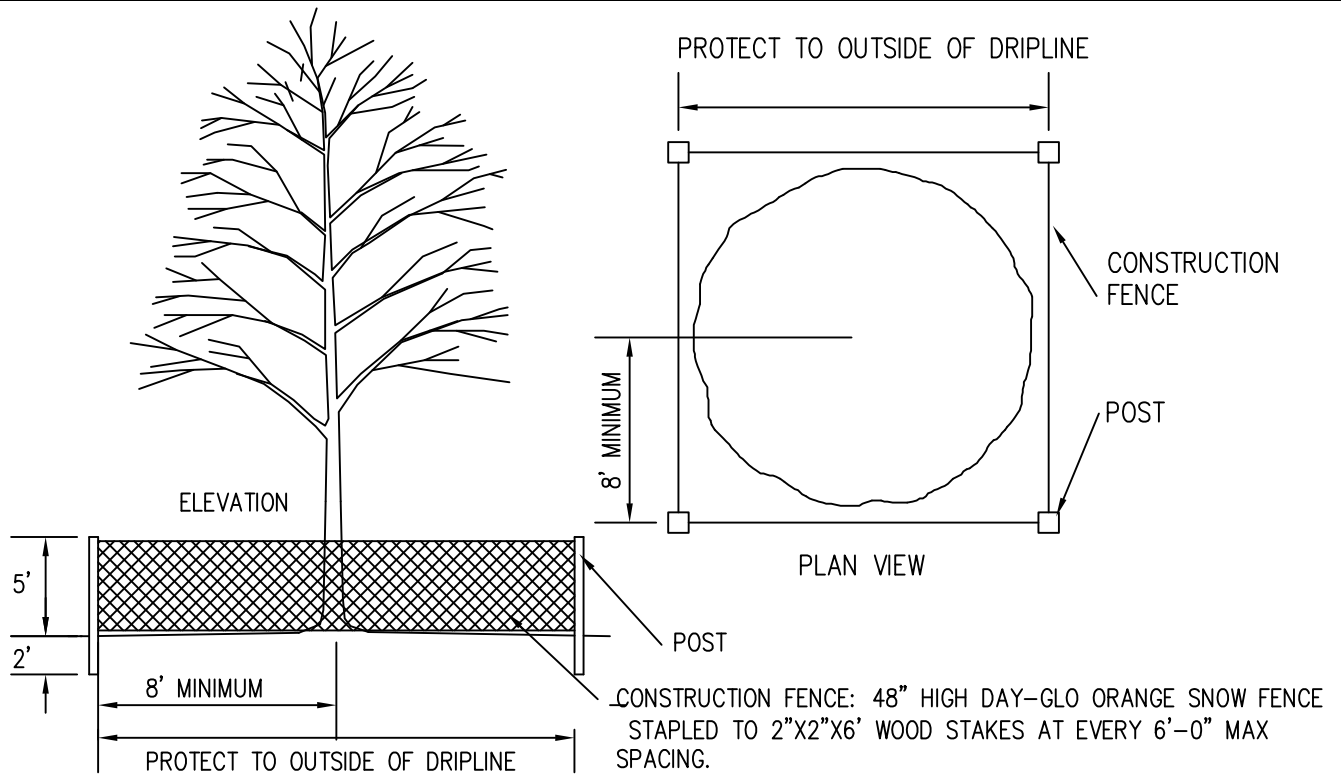

Tree Protection

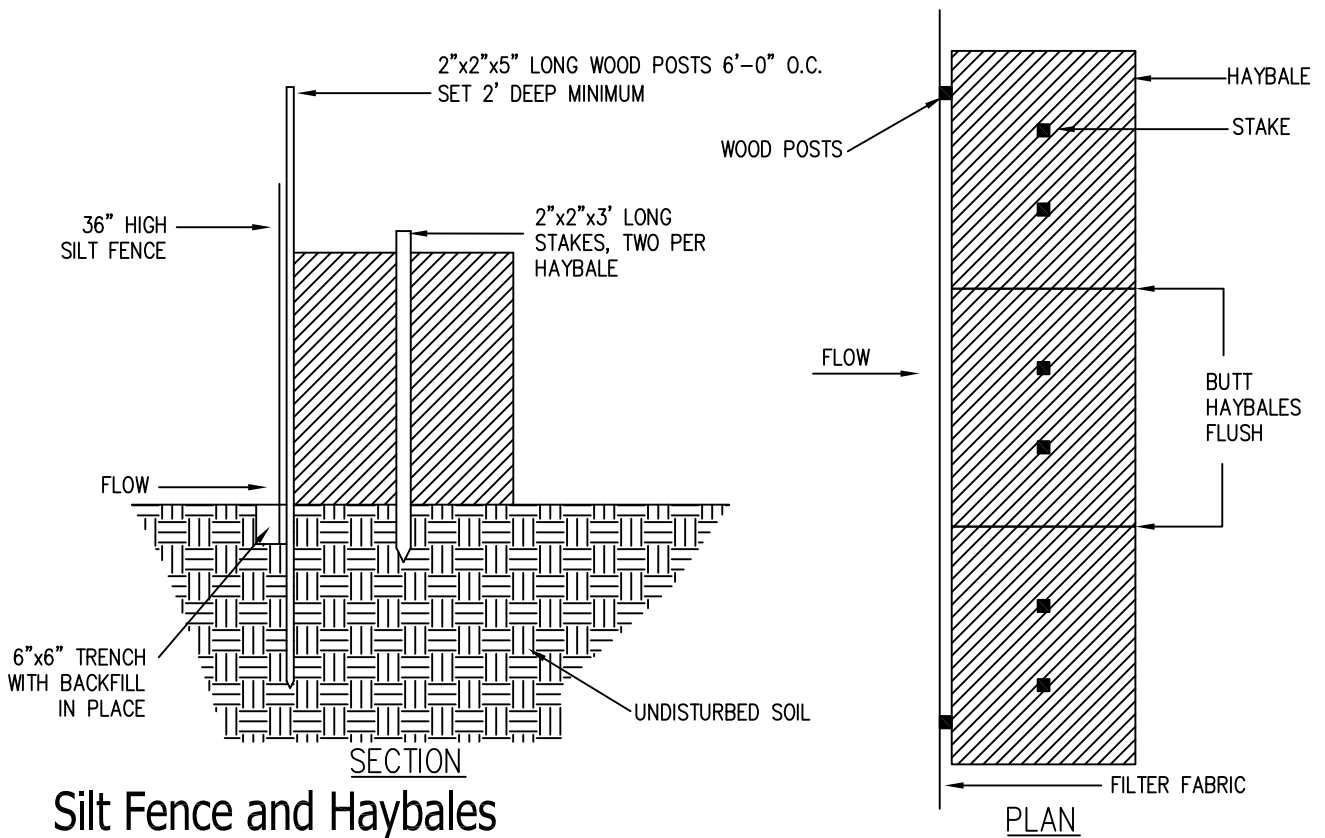

Silt Fence and Haybales



Dept. Of Public Works & Parks
 Capital Projects Division
 ROBERT C. ANTONELLI, JR.
 Assistant Commissioner

Parks, Recreation & Cemetery Division Standard
 Details - Tree Protection & Silt Fence and Haybales

Not to Scale

D-7

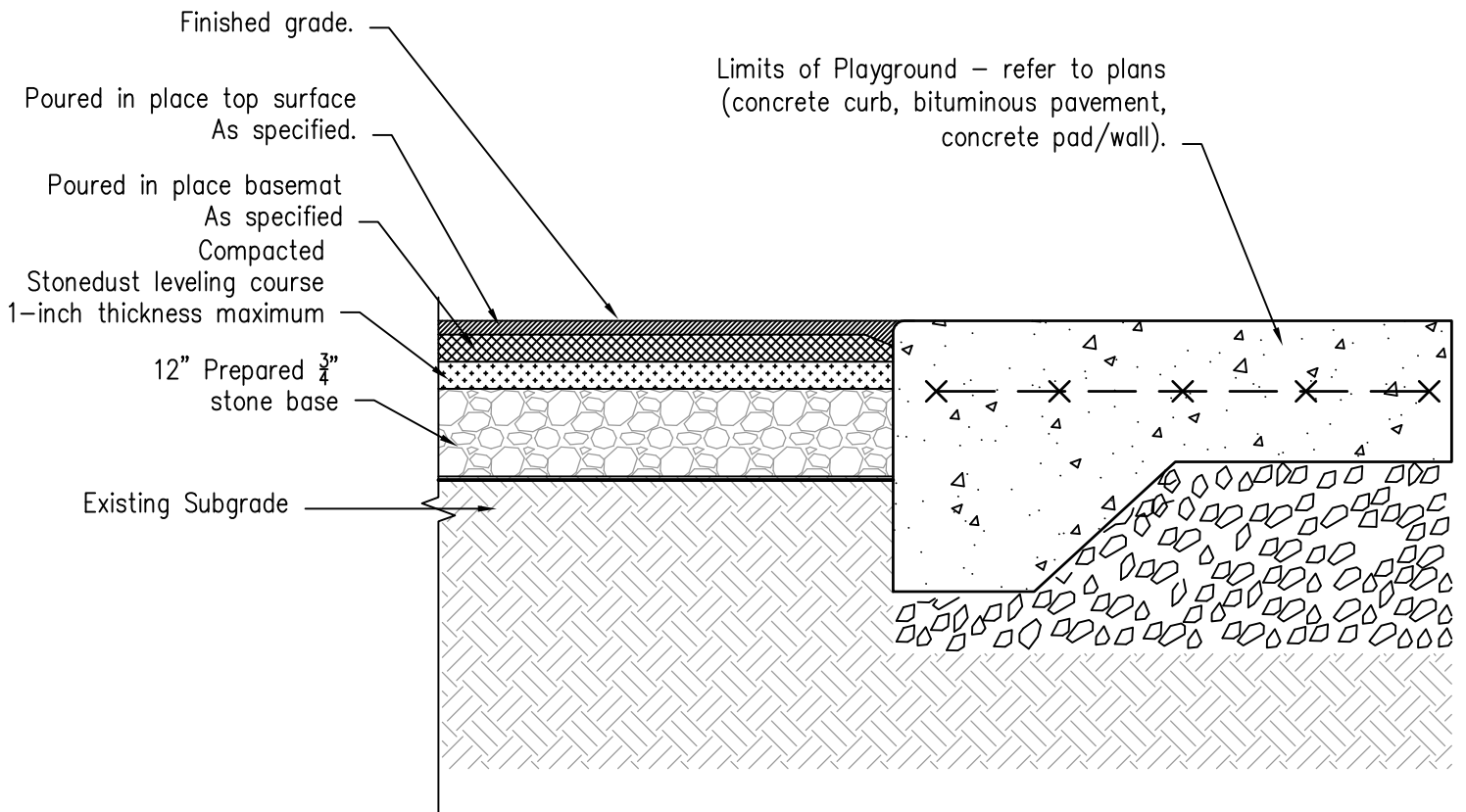

Dept. Of Public Works & Parks
Capital Projects Division
ROBERT C. ANTONELLI, JR.
Assistant Commissioner

Parks, Recreation & Cemetery Division Standard Details - Poured in Place Safety Surfacing Profile

Not to Scale

D-9